



ALERT

SERVICE BULLETIN

NUMBER: SB 500-52-008, REV B
MODEL: ECLIPSE EA500
SUBJECT: MAIN LANDING GEAR-LOWER DOOR AERO SEAL MODIFICATION

1. PLANNING INFORMATION

A. Effectivity

Aircraft Serial Numbers 000001-000104.

B. Reason

Performance of this modification will prevent the possibility of interference between the main landing gear lower aero door seal and main gear tire.

Revision B adds compliance using of SEM 500-0092 Rev A. Additionally, it is not necessary to remove the door to accomplish the intent of this Service Bulletin.

C. Description

This Service Bulletin reworks the Aero Seals on each Main Landing Gear-Lower Door for adequate clearance from the tire.

D. Relevant Publications

Aircraft Maintenance Manual (AMM) P/N 06-117751, latest revision.

E. Compliance

Eclipse Aviation Corporation considers this to be a mandatory inspection that must be accomplished within 30 days or 10 hours, whichever occurs first, from the issue date of this SB.

Compliance with revision A of this Service Bulletin or SEM 500-0092 Rev A constitutes compliance with revision B.

F. Approval

This Service Bulletin is based on engineering data that is FAA-approved, and the modification herein complies with the applicable regulations.

G. Labor Requirements

The following information is for planning purposes only.

(1) Estimated labor hours to perform:

Suggested number of personnel: 1

Main Landing Gear-Lower Doors removal and installation: 0.5 Hours

Main Landing Gear-Lower Door Aero Seals rework: 0.5 Hours

Total labor hours: 1.0

The above is an estimate based on properly equipped and experienced personnel complying with this Service Bulletin. Actual labor hours may vary depending on workforce experience, concurrent maintenance, discovery of other discrepancies, etc.

(2) Qualification of personnel:

- A person properly authorized under 14 CFR 43 to perform aircraft maintenance.

SERVICE BULLETIN

H. References

Aircraft Maintenance Manual (AMM) P/N 06-117751, latest revision.

I. Publications Affected

Aircraft Maintenance Manual (AMM) P/N 06-117751, latest revision.

2. MATERIAL INFORMATION

A. Materials

There are no Serialized Parts and Kits required for this Service Bulletin.

3. ACCOMPLISHMENT INSTRUCTIONS

A. Procedure

NOTE: The following is the suggested procedure to rework the main landing gear lower aero door seal. Alternative means may be used to accomplish the intent of this Service Bulletin. These include removal of the bracket from the door and rework on the aircraft without removing the door or bracket and seal.

- (1) Make aircraft safe for maintenance. Refer to AMM 20-00-01.
- (2) Remove left Main Landing Gear-Lower Door. Refer to AMM 52-82-11 Main Landing Gear-Lower Door Assembly Removal
- (3) Mark and rework aero seal (P/N 52-109214-2002) to obtain $1.1 \pm .1$ inch from retaining bracket (P/N 52-114011-2001). Refer to [Figure. 1](#).

SERVICE BULLETIN

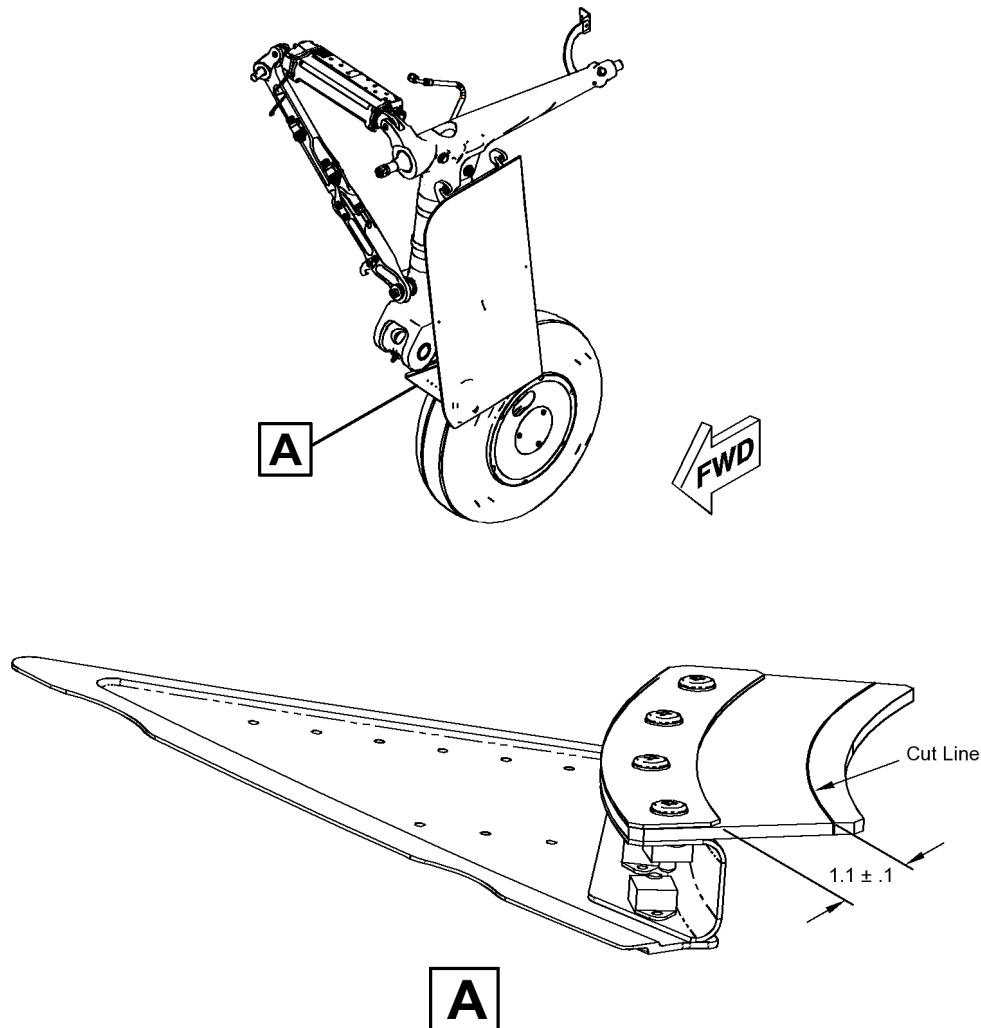

3D VIEW
ROTATED FOR CLARITY

5080093A

Main Landing Gear-Lower Door Aero Seal Figure 1

- (4) Install left Main Landing Gear-Lower Door. Refer to AMM 52-82-11 Main Landing Gear-Lower Door Assembly Installation. The adjustment/test of the MLG Doors referred to in the Main Gear Lower Door Assembly - Installation (AMM 52-82-11) does not need to be accomplished as part of this Service Bulletin
- (5) Repeat steps 2 through 4 on right Main Landing Gear-Lower Door.
- (6) If all other maintenance is complete, return aircraft to service. Refer to AMM 20-00-02.



ALERT

SERVICE BULLETIN

B. Limitations and Procedures

None

C. Cost

Parts and Labor will be supplied by Eclipse Aviation Corporation at no charge to the aircraft owner.

4. RECORD OF COMPLIANCE

Upon completion of this Service Bulletin, make an appropriate maintenance-record entry specifying the Service Bulletin number.

5. NOTIFYING ECLIPSE AVIATION

On completing this service bulletin, the operator/maintainer shall complete the attached Compliance Record and send it to Eclipse Aviation via regular mail, fax, or e-mail.

MAILING ADDRESS	Eclipse Aviation Corporation ATTN: Customer Care 4100 Aerospace Parkway Albuquerque, NM 87121
FAX	1-505-241-8802
E-MAIL	customercare@EclipseAviation.com

